



## Sagard Facilities

### Assembly Shop - Sagard

#### Bay 1- 60' x 3000

- Cranes - full coverage
- Munck (2) - 10 ton 23'6" under hook
- Demag - 5 ton 23'6" under hook
- Shipping door - level 14 x 16

#### Miscellaneous

- Fork trucks Clark 10,000 lb. Hyster 10,000 lb
- Paint booth 12' x 36'
- Shot blast 20 x 20 50 HP Air
- Stores 2,800 square feet
- Outside storage 60,000 square feet

### Weld Shop 8,800 square feet

Current capacity - 22,000 man hours  
Maximum capacity - 40,000 man hours

#### Welding Machines:

- (9) Miller 400 Amp MIG auto wire feed
- (1) Miller 375 Amp Stick
- (3) CLA 300 Amp MIG auto wire feed

#### Cranes - full coverage

- Kone - 5 ton (2) 23'6" under the hook

#### Shipping Door 14 x 16

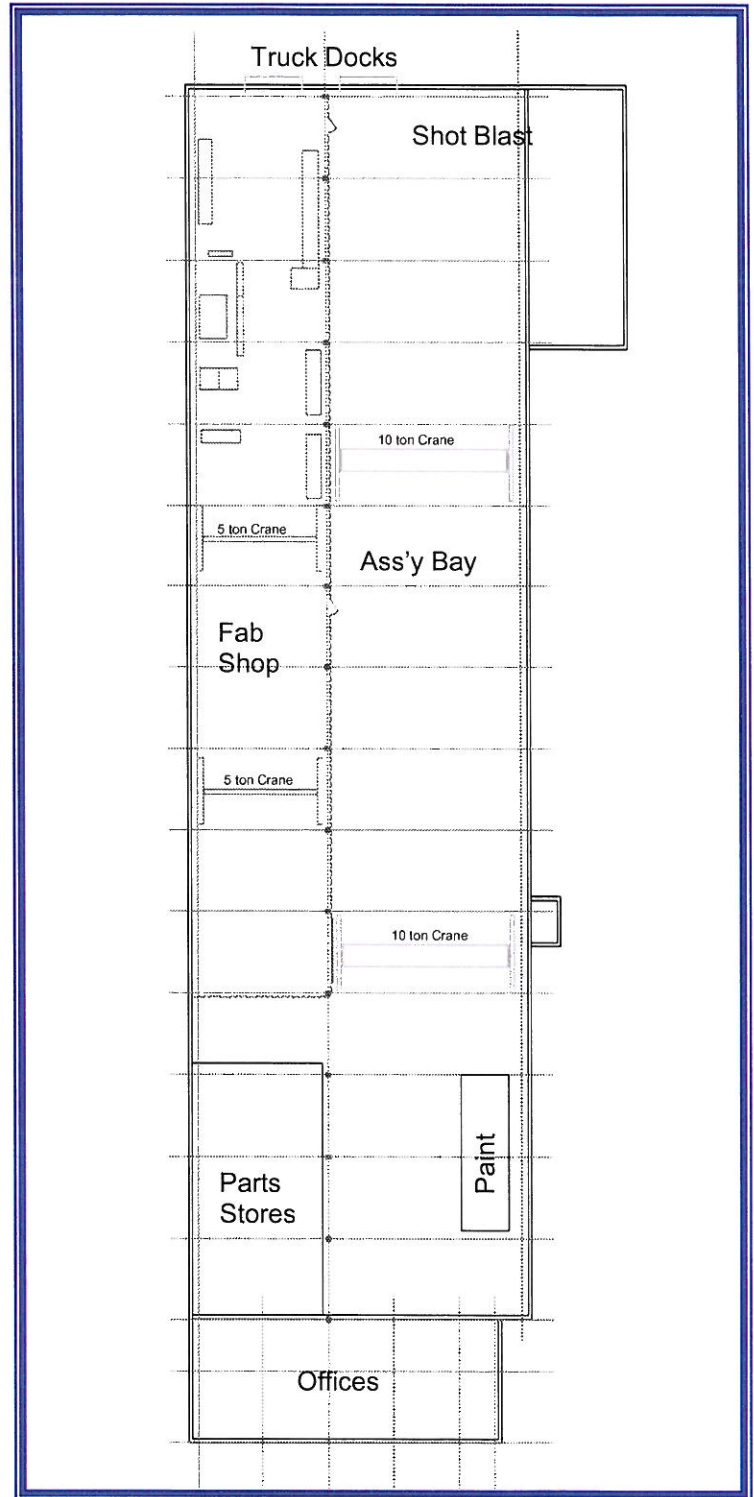
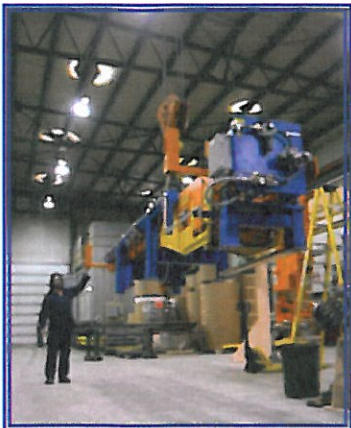

615 Sagard, 33,000 square feet